

| TUNERS / CASSETTE / DISC PLAYERS |                                   |                                   |                                   |                                   |                                   | RADIO<br>EQ<br>STACK              |
|----------------------------------|-----------------------------------|-----------------------------------|-----------------------------------|-----------------------------------|-----------------------------------|-----------------------------------|
|                                  | MINI                              | STAN                              | DIN                               | ISO DIN                           | SINGLE<br>DBL DIN                 |                                   |
| CHASSIS H                        | 1 $\frac{3}{8}$ -2                | 2                                 | 2                                 | 2                                 | 3 $\frac{7}{8}$                   | 3                                 |
| CHASSIS W                        | 7 $\frac{1}{8}$                   | 7 $\frac{1}{8}$                   | 7 $\frac{1}{8}$                   | 7                                 | 7 $\frac{1}{8}$                   | 7 $\frac{1}{8}$                   |
| CHASSIS D                        | 4 $\frac{3}{4}$ -5 $\frac{1}{2}$  | 5 $\frac{7}{8}$ -6 $\frac{1}{16}$ | 5 $\frac{7}{8}$ -6 $\frac{1}{16}$ | 5 $\frac{7}{8}$ -6 $\frac{1}{16}$ | 5 $\frac{7}{8}$ -6 $\frac{1}{16}$ | 5 $\frac{7}{8}$ -6 $\frac{1}{16}$ |
| NOSE H                           | 1 $\frac{3}{8}$ -1 $\frac{3}{4}$  | 1 $\frac{3}{8}$ -1 $\frac{3}{4}$  | 2 $\frac{3}{8}$                   | 1 $\frac{3}{16}$                  | 3 $\frac{3}{4}$ -4                |                                   |
| NOSE W                           | 4 $\frac{1}{4}$ -4 $\frac{3}{16}$ | 4 $\frac{1}{4}$ -4 $\frac{3}{16}$ | 7 $\frac{1}{2}$                   | 6 $\frac{1}{16}$                  | 6 $\frac{1}{16}$ -7 $\frac{1}{4}$ |                                   |
| SHAFT SP.                        | 5 $\frac{1}{8}$ -5 $\frac{3}{4}$  | 5 $\frac{1}{4}$ -6                |                                   |                                   |                                   |                                   |

### IN DASH APPLICATION NOTES

|  |                |                |                |                |                  |                |
|--|----------------|----------------|----------------|----------------|------------------|----------------|
|  | K <sup>S</sup> | K <sup>S</sup> | K <sup>S</sup> | K <sup>S</sup> | K <sup>S</sup> * | K <sup>S</sup> |
|--|----------------|----------------|----------------|----------------|------------------|----------------|

|                        |      |                   |       |
|------------------------|------|-------------------|-------|
| APPLICATION KIT MODEL: |      | GM1580 / GM1590 * |       |
| HARNESS ADAPTOR:       | GM03 | ANTENNA ADAPTOR:  | MDA-1 |

### IN-DASH INSTALLATION AREA DIMENSIONS

|                        | DEPTH                           | MAX DEPTH   | WIDTH                                      | HEIGHT                            |
|------------------------|---------------------------------|---|--|-----------------------------------|
| CAVITY                 | 6 <sup>1</sup> / <sub>4</sub> " | 7 <sup>1</sup> / <sub>2</sub> "   | 7 <sup>3</sup> / <sub>8</sub> "            | 5 <sup>3</sup> / <sub>4</sub> "   |
| DASH OPENING           | TYPE: GM Oversize               |   | 7 <sup>3</sup> / <sub>32</sub> "           | 3 <sup>15</sup> / <sub>16</sub> " |
| DASH MATERIAL: PLASTIC |                                 |   | THICKNESS: 1 <sup>1</sup> / <sub>8</sub> " |                                   |
| FOR MAX DEPTH          |                                 | <input type="checkbox"/> REMOVE REAR SUPPORT<br><input checked="" type="checkbox"/> MODIFY CAVITY |  |                                   |

### AMPLIFIER/EQ MOUNTING LOCATIONS (WxHxD)

| UNDER/IN DASH | UNDER SEAT | GLOVE BOX | TRUNK/ CARGO |
|---------------|------------|-----------|--------------|
|               |            |           | Various      |

Dimensions shown are inches.  
For inch/mm conversions refer to chart section.

\* For ISO mount double DIN radios only.

UPDATED  
THROUGH  
'99 ☐  
2000 ☐  
2001 ☐  
2002 ☐

# BUICK 1997-UP CENTURY

Sedan

### REAR DECK - SEDAN

Factory Provisions: 6 x 9" in a factory spacer

Aftermarket: 5 $\frac{1}{4}$ "K, 6 $\frac{1}{2}$ "K

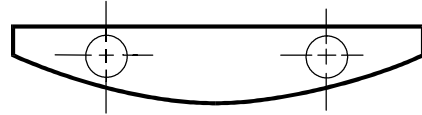

CAVITY W H D  
5 $\frac{7}{8}$  x 8 $\frac{7}{8}$  x 3 $\frac{1}{2}$ "

### FRONT DOORS

Factory Provisions: 5 $\frac{1}{4}$ " in a factory adapter

Aftermarket: 5 $\frac{1}{4}$ ", 6 $\frac{1}{2}$ "C<sup>1</sup>

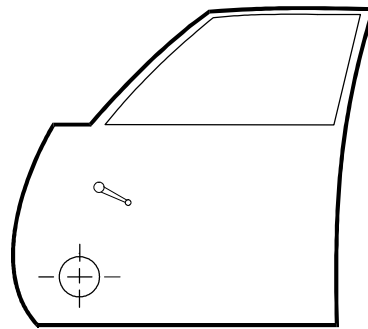

CAVITY W H D  
5 x 5 x 2 $\frac{5}{8}$ " \*\*

\*\* + 1" to glass if adapter is modified

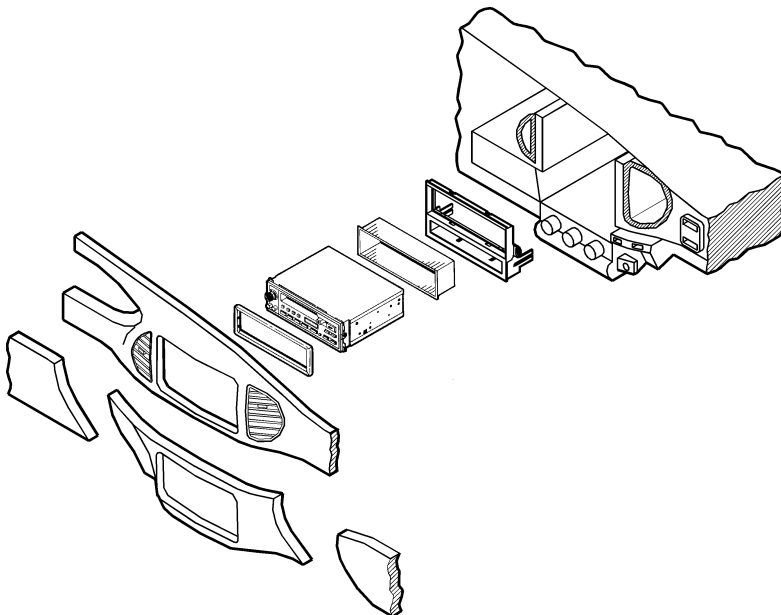

NOTE: THIS MANUAL IS BASED ON CAREFULLY DOCUMENTED RESEARCH. ABSOLUTE ACCURACY IS ATTEMPTED BUT NOT GUARANTEED. USE THIS MANUAL AS A REFERENCE GUIDE. SCOSCHE, INC. CANNOT BE RESPONSIBLE FOR INCONSISTENCIES THAT MAY OCCUR.

- B = BACK UP PLATES REQUIRED.
- C<sup>1</sup> = CUT TRIM/PLASTIC (STRUCTURE).
- C<sup>2</sup> = CUT STEEL.
- D = BELOW DECK ONLY.
- D<sup>1</sup> = LIFT PORTION OF DECK. (MAY REQUIRE STRUCTURAL REINFORCEMENT).
- D<sup>2</sup> = CUT STEEL WHEN TOP MOUNTED. DO NOT IF BELOW DECK.
- D<sup>3</sup> = NARROW SURFACE, BELOW DECK ONLY.
- F<sup>1</sup> = MINIMUM MODIFICATION FILE SHAFT HOLES OR DASH OPENING.
- F<sup>2</sup> = MODIFY DASH CAVITY AND/OR PANEL.
- K = INSTALLATION KIT, SPACER OR ADAPTOR REQUIRED.
- K<sup>1</sup> = KIT MODIFICATIONS REQUIRED.
- K<sup>2</sup> = EXTENSION KIT RECOMMENDED.
- K<sup>3</sup> = WHEN EQUIPPED WITH FACTORY "ELECTRONIC" RADIO.
- K<sup>4</sup> = FABRICATE PANEL/BRAKETS.

- K<sup>S</sup> = WHEN EQUIPPED WITH STANDARD TWO SHAFT RADIO/TAPE PLAYER. FABRICATE KIT WHEN EQUIPPED WITH FLAT FACE ELECTRONIC RADIO/TAPE PLAYER.
- K<sup>S</sup> = SCOSCHE KIT RECOMMENDED.
- N = NOT RECOMMENDED. EXTENSIVE MODIFICATION REQUIRED.
- P = PERFECT WITHOUT MODIFICATION.
- P<sup>1</sup> = MODIFY OR REMOVE POCKETS.
- P<sup>2</sup> = COIN POCKET LOCATION IN DASH (MAY REQUIRE TRIM KIT).
- P<sup>3</sup> = PERFECT WHEN EQUIPPED WITH STANDARD TWO SHAFT RADIO, K WITHOUT.
- R = REAR LOAD ISOMOUNT.
- U = UNDERDASH.
- W<sup>1</sup> = WITH POWER WINDOWS ONLY.
- W<sup>2</sup> = WITHOUT POWER WINDOWS ONLY.

# 1997-UP BUICK CENTURY SEDAN



CD PLAYER INSTALL WITH SCOSCHE GM1580 KIT.

**PRELIMINARY:** DISCONNECT THE NEGATIVE BATTERY CABLE

**ANTENNA:** THE FACTORY ANTENNA IS LOCATED IN THE REAR WINDOW GLASS.

## RADIO REMOVAL AND IN-DASH INSTALLATION:

**NOTE:** THE FACTORY RADIO PROVISION IS FOR A GM OVERSIZE RADIO CHASSIS. AN INSTALLATION KIT IS RECOMMENDED FOR AFTERMARKET INSTALLATIONS. WE RECOMMEND THE USE OF A SCOSCHE GM1580 KIT FOR NORMAL INSTALLATIONS OF DIN OR SHAFT RADIOS, OR GM1590 KIT FOR CUSTOM INSTALLATIONS OF JAPANESE DOUBLE DIN ISO OR 2 STACKED DIN ISO RADIOS.

1. EXTRACT (1) SCREW FROM BOTTOM LOWER DASH PANEL AT RIGHT OF GLOVE BOX.
2. OPEN GLOVE BOX AND POP OUT SMALL LOWER DASH PANEL ALONG THE RIGHT SIDE.
3. CAREFULLY POP OUT FUSE BOX COVER AT RIGHT SIDE OF DASH AND EXTRACT (1) SCREW FROM THE DASH BEZEL AT THE RIGHT OF THE AIR VENT.
4. EXTRACT (2) SCREWS AT THE BOTTOM OF THE LOWER DASH TRAY/ LIGHTER DASH SECTION POP OUT AND REMOVE.
5. EXTRACT (1) SCREW FROM THE RIGHT DRIVER'S SIDE LOWER DASH PANEL AND ONE PANEL POPPER FROM THE LEFT SIDE.
6. CAREFULLY POP OUT THE DRIVER'S SIDE LOWER DASH PANEL AND REMOVE.
7. PUT THE VEHICLE INTO FIRST OR LOW GEAR, AND TILT THE STEERING COLUMN ADJUSTMENT ALL THE WAY DOWN AND PULL OUTWARD ON THE COMPLETE DASH PANEL TO UNSNAP, UNPLUG, AND REMOVE PANEL.
8. EXTRACT (3) 7 MM SCREWS HOLDING RADIO, UNPLUG CONNECTOR, ANTENNA CABLE AND REMOVE RADIO.

## FRONT DOOR SPEAKER INSTALLATION:

**NOTE:** THE FACTORY PROVISION IS FOR 5 1/4" SPEAKER AND TWEETER.

1. EXTRACT (1) SCREW FROM DOOR RELEASE CUP, UNSNAP, UNPLUG TWEETER AND REMOVE THE TRIM.
2. UNSNAP POWER WINDOW SWITCH PANEL, UNPLUG AND REMOVE.
3. REMOVE SCREW COVER BOTTOM OF ARMREST CUP AND EXTRACT (2) TORX SCREWS FROM BEHIND.
4. USE A PANEL REMOVAL TOOL TO POP OUT FASTENERS ON ALL SIDES OF THE PANEL, UNPLUG TWEETER (IF EQUIPPED) LIFT AWAY AND REMOVE.
5. EXTRACT (4) SCREWS HOLDING SPEAKER IN ADAPTER, UNPLUG AND REMOVE.

## REAR DECK SPEAKER INSTALLATION:

**NOTE:** THE FACTORY SPEAKER PROVISION IS FOR 6 X 9" SPEAKER IN A SPACER/ADAPTER.

1. POP UP THE FRONT EDGE OF BOTTOM REAR SEAT CUSHION, LIFT AWAY AND REMOVE.
2. EXTRACT (2) 10 MM WASHER BOLTS FROM BELOW REAR SEAT UPRIGHT CUSHION LIFT CUSHION UP TO REMOVE.
3. USE A PANEL REMOVAL TOOL TO POP OUT (3) FASTENERS FROM FRONT OF THE REAR DECK PANEL.
4. FROM INSIDE THE TRUNK, TWIST AND RELEASE (2) 3RD BRAKE LAMP BULBS FROM THEIR HOUSINGS.
5. LIFT REAR DECK UP, SLIDE TOWARDS FRONT OF VEHICLE, UNPLUG AND REMAINING WIRING, AND REMOVE.
6. FROM INSIDE TRUNK, UNSNAP SPEAKER/SPACER, LIFT UP, UNPLUG, AND REMOVE THE ASSEMBLY.

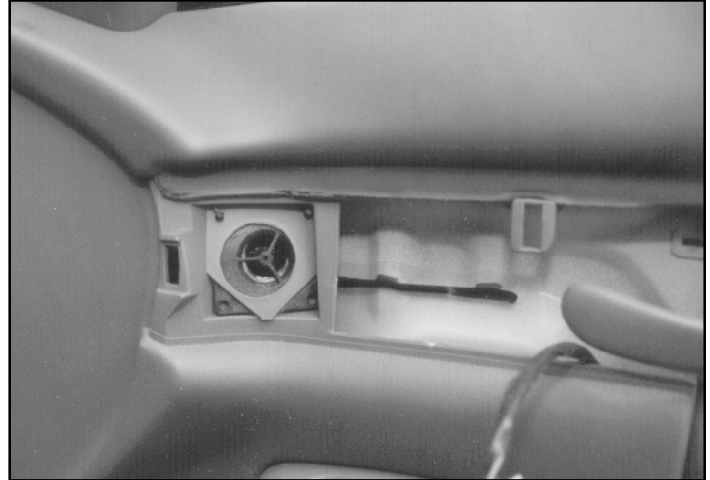

FRONT DOOR TWEETER PROVISION.

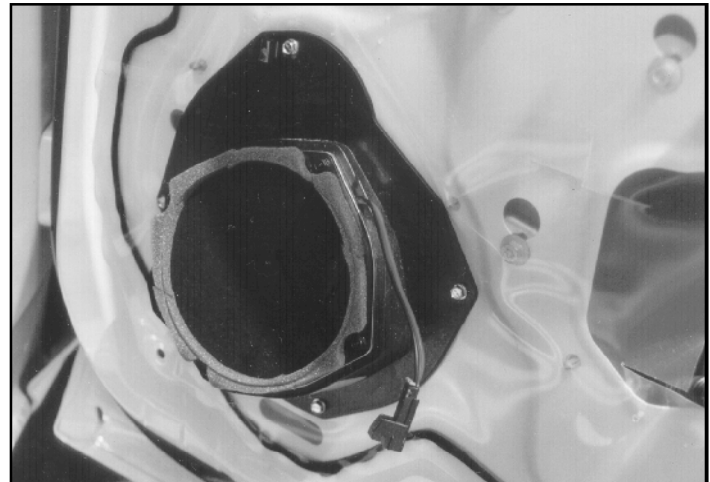

FRONT DOOR 5 1/4" IN A FACTORY ADAPTER.



REAR DECK 6 X 9" SPEAKER IN ADAPTER/SPACER.